



DISCLOSURE STATEMENT: LOCATION MAP

This form approved by the Minnesota Association of REALTORS®, which disclaims any liability arising out of use or misuse of this form. © 2021 Minnesota Association of REALTORS®

1. Page _____ of _____ pages

2. Please use the space below to sketch the real property being sold and, to Seller's knowledge, the approximate location of any of the following on the property.

4. SUBSURFACE SEWAGE TREATMENT SYSTEM WELL METHAMPHETAMINE PRODUCTION AREA
------(Check all that apply.)-----

5. Include approximate distances from fixed reference points such as streets, buildings and landmarks.

6. Property located at 14745 County Road 40 Carver MN 55315

7. S25/T115/R024 home on approximately 49.33 +/- acres see attached legal description

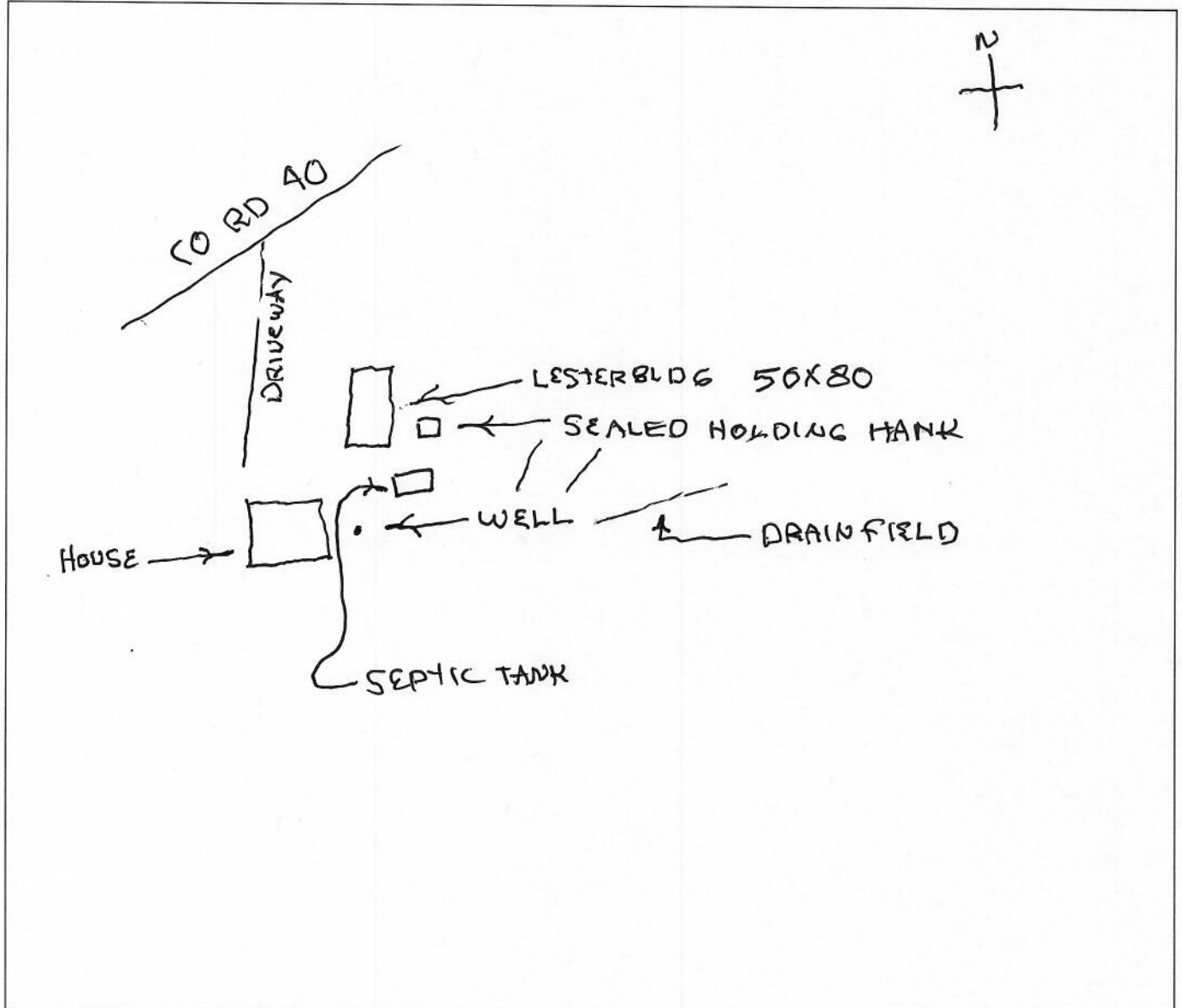

8. ATTACH ADDITIONAL SHEETS AS NEEDED.

9. Seller and Buyer initial: OGP 07/22/24
(Seller) (Date) (Buyer) (Date)

10. _____
(Seller) (Date) (Buyer) (Date)

11. ORIGINAL COPY TO LISTING BROKER; COPIES TO SELLER, BUYER, SELLING BROKER