



DISCLOSURE STATEMENT: LOCATION MAP

This form approved by the Minnesota Association of REALTORS®, which disclaims any liability arising out of use or misuse of this form. © 2021 Minnesota Association of REALTORS®, Minnetonka, MN

1. Page _____ of _____ pages

2. Please use the space below to sketch the real property being sold and, to Seller's knowledge, the approximate location of
3. any of the following on the property.

4. ☒ SUBSURFACE SEWAGE TREATMENT SYSTEM ☒ WELL ☐ METHAMPHETAMINE PRODUCTION AREA
(Check all that apply.)

5. Include approximate distances from fixed reference points such as streets, buildings and landmarks.

6. Property located at 22991 Woodland Rd Lakeville MN 55044

7. S01/T113/R021 Home on approximately 20 +/- acres see attached legal description

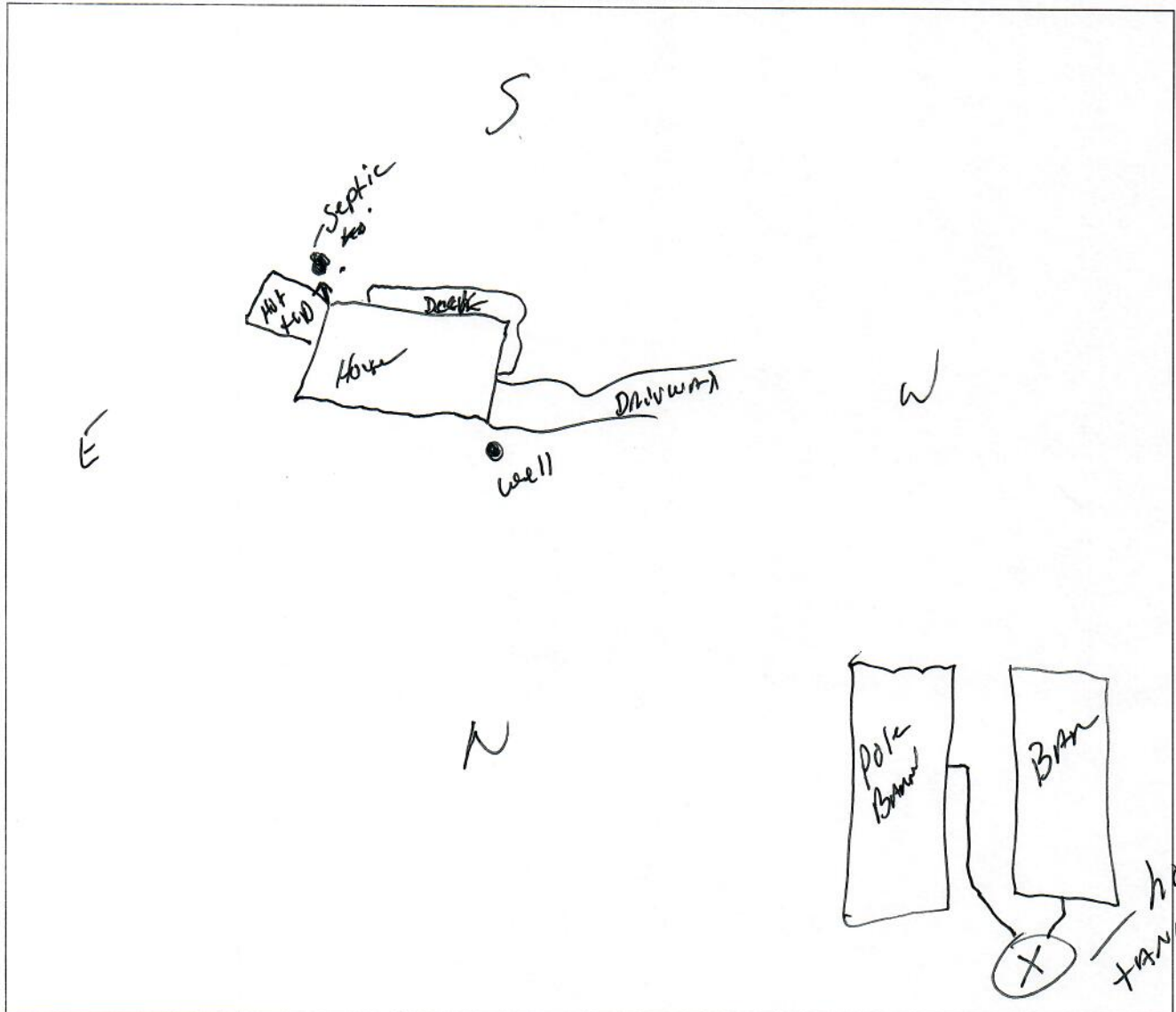

8. ATTACH ADDITIONAL SHEETS AS NEEDED.

9. Seller and Buyer initial:

[Signature] 12/5/22
(Seller) (Date) (Buyer) (Date)

(Seller) (Date) (Buyer) (Date)

11. ORIGINAL COPY TO LISTING BROKER; COPIES TO SELLER, BUYER, SELLING BROKER