

# Soils Map

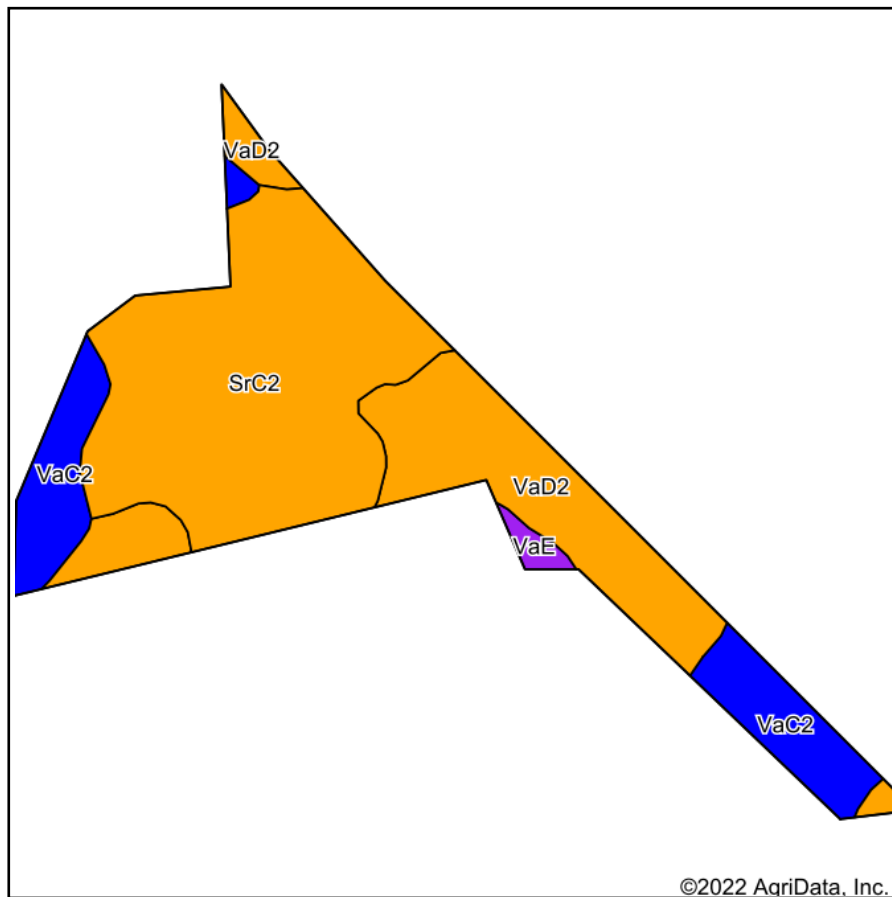

Soils data provided by USDA and NRCS.

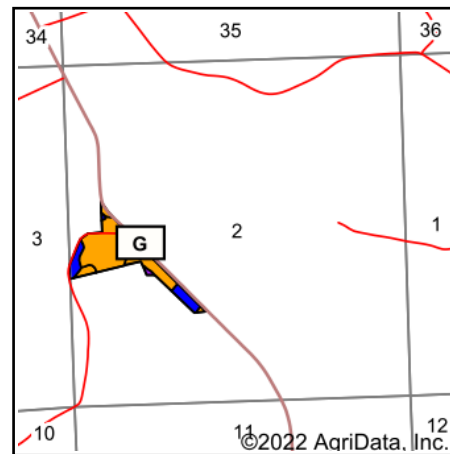

State: **Wisconsin**  
 County: **Sauk**  
 Location: **2-9N-3E**  
 Township: **Bear Creek**  
 Acres: **19.72**  
 Date: **8/24/2022**



WEISS REALTY  
 RENTING & LAND SERVICES

Maps Provided By:



© AgriData, Inc. 2021

www.AgriDataInc.com



Area Symbol: WI111, Soil Area Version: 19								
Code	Soil Description	Acres	Percent of field	Non-Irr Class Legend	Non-Irr Class *c	*n NCCPI Overall	*n NCCPI Corn	*n NCCPI Soybeans
SrC2	Seaton silt loam, driftless ridge, 6 to 12 percent slopes, moderately eroded	10.30	52.2%		IIIe	84	84	81
VaD2	Valton silt loam, 12 to 20 percent slopes, moderately eroded	5.79	29.4%		IIIe	65	65	60
VaC2	Valton silt loam, 6 to 12 percent slopes, moderately eroded	3.37	17.1%		Ile	71	71	69
VaE	Elbaville silt loam, 20 to 30 percent slopes, moderately eroded	0.26	1.3%		Vle	17	17	10
Weighted Average					2.87	*n 75.3	*n 75.3	*n 71.8

\*n: The aggregation method is "Weighted Average using all components"

\*c: Using Capabilities Class Dominant Condition Aggregation Method

Soils data provided by USDA and NRCS.