

Soils Map

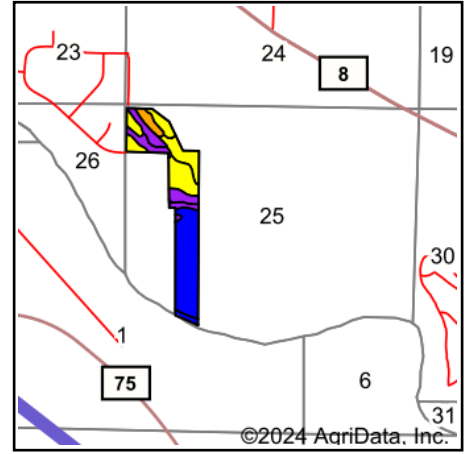

State: **Minnesota**
 County: **Sherburne**
 Location: **25-34N-30W**
 Township: **Clear Lake**
 Acres: **46.61**
 Date: **6/30/2024**

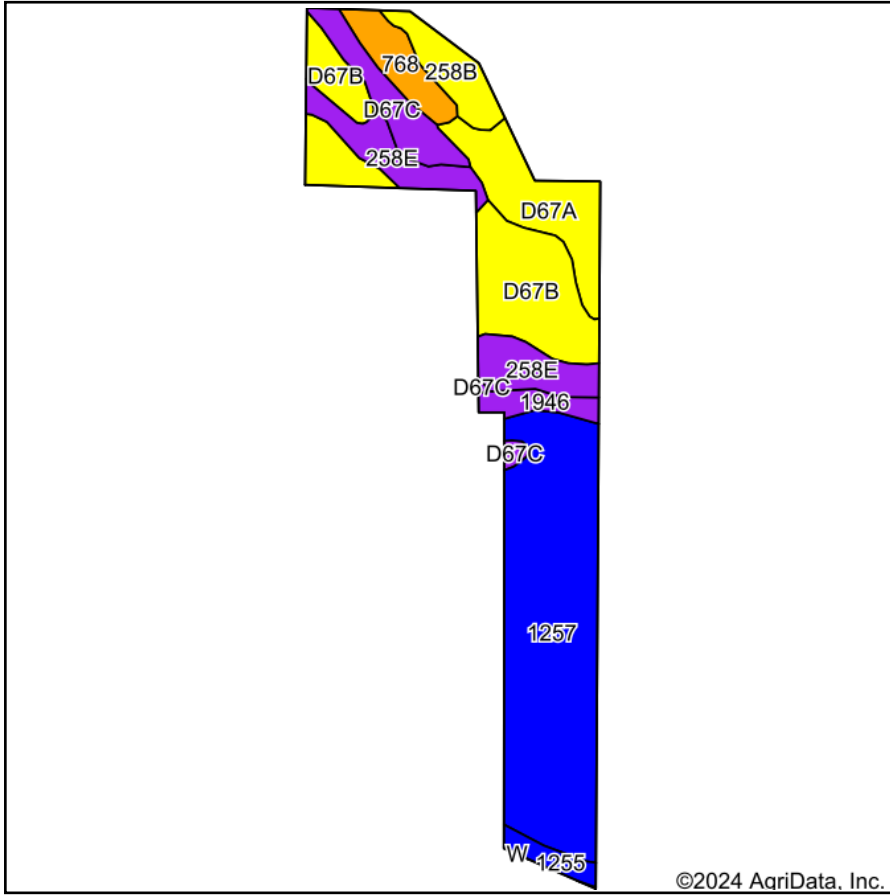

Maps Provided By:



Area Symbol: MN141, Soil Area Version: 21

Code	Soil Description	Acres	Percent of field	Non-Irr Class Legend	Non-Irr Class *c	Irr Class *c	*n NCCPI Overall	*n NCCPI Corn	*n NCCPI Soybeans
1257	Elkriver-Mosford complex, 0 to 6 percent slopes, rarely flooded	17.98	38.7%			IIIs	63	63	44
D67B	Hubbard loamy sand, 1 to 6 percent slopes	9.15	19.6%			IVs	44	44	25
D67A	Hubbard loamy sand, 0 to 2 percent slopes	4.95	10.6%			IVs	44	44	25
258E	Sandberg loamy coarse sand, 6 to 30 percent slopes	4.87	10.4%			VIIIs	21	21	10
D67C	Hubbard loamy sand, 2 to 12 percent slopes	2.98	6.4%			VIIs	42	42	24
258B	Sandberg loamy sand, 1 to 6 percent slopes	2.34	5.0%			IVs	39	38	20
768	Mosford sandy loam, 0 to 2 percent slopes	2.25	4.8%			IIIIs	55	55	34
1946	Fordum-Winterfield complex, 0 to 2 percent slopes, frequently flooded	1.18	2.5%			VIw	39	16	8
1255	Elkriver fine sandy loam, 0 to 2 percent slopes, occasionally flooded	0.91	2.0%			IIw	67	67	48
Weighted Average					3.63	*-	*n 49.4	*n 48.8	*n 30.9

*n: The aggregation method is "Weighted Average using all components"

*c: Using Capabilities Class Dominant Condition Aggregation Method

*- Irr Class weighted average cannot be calculated on the current soils data due to missing data.