

Soils Map

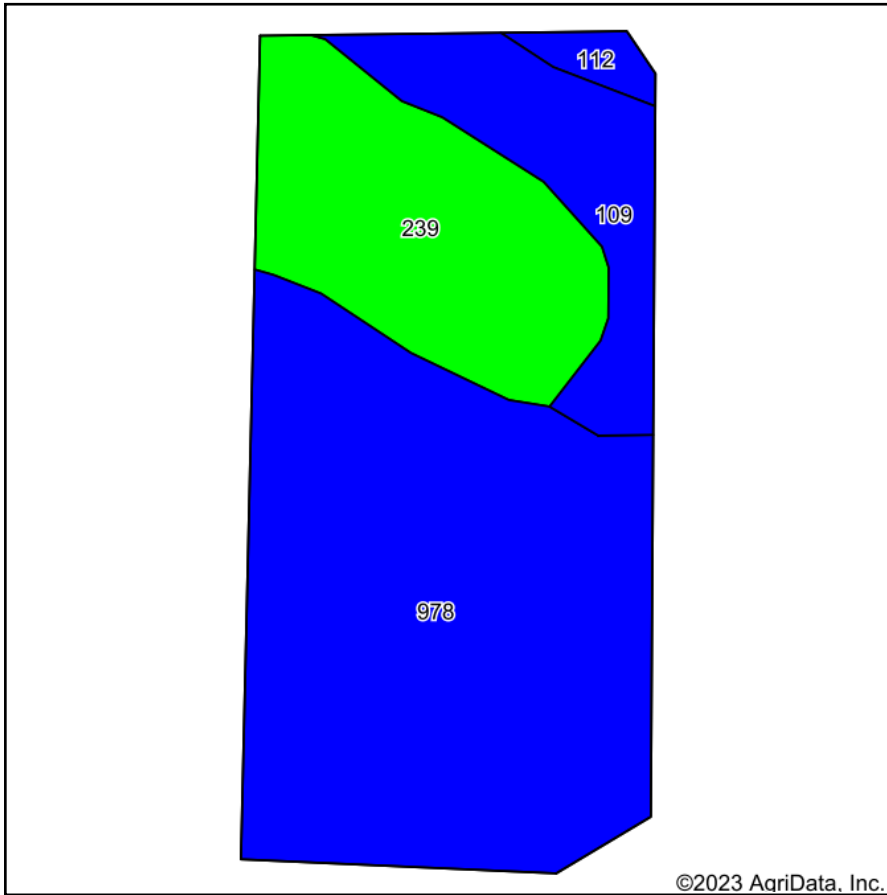

Soils data provided by USDA and NRCS.

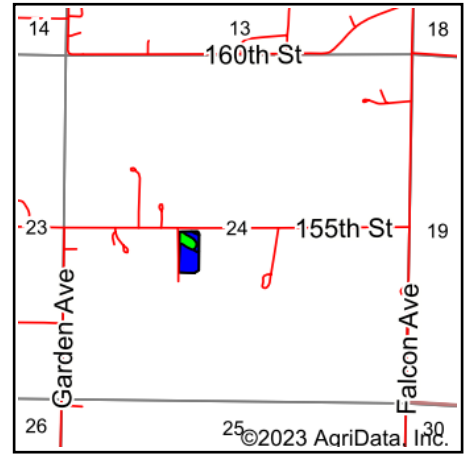

State: **Minnesota**
 County: **McLeod**
 Location: **24-116N-28W**
 Township: **Rich Valley**
 Acres: **4.36**
 Date: **8/9/2023**



Maps Provided By:



Area Symbol: MN085, Soil Area Version: 20								
Code	Soil Description	Acres	Percent of field	Non-Irr Class Legend	Non-Irr Class *c	*n NCCPI Overall	*n NCCPI Corn	*n NCCPI Soybeans
978	Cordova-Rolfe complex, 0 to 2 percent slopes	2.64	60.6%		IIw	84	84	77
239	Le Sueur loam, 1 to 3 percent slopes	1.05	24.1%		Iw	90	90	84
109	Cordova clay loam, 0 to 2 percent slopes	0.59	13.5%		IIw	85	85	82
112	Harps clay loam, 0 to 2 percent slopes	0.08	1.8%		IIw	82	70	82
Weighted Average					1.76	*n 85.5	*n 85.3	*n 79.5

*n: The aggregation method is "Weighted Average using all components"

*c: Using Capabilities Class Dominant Condition Aggregation Method

Soils data provided by USDA and NRCS.