

# Soils Map

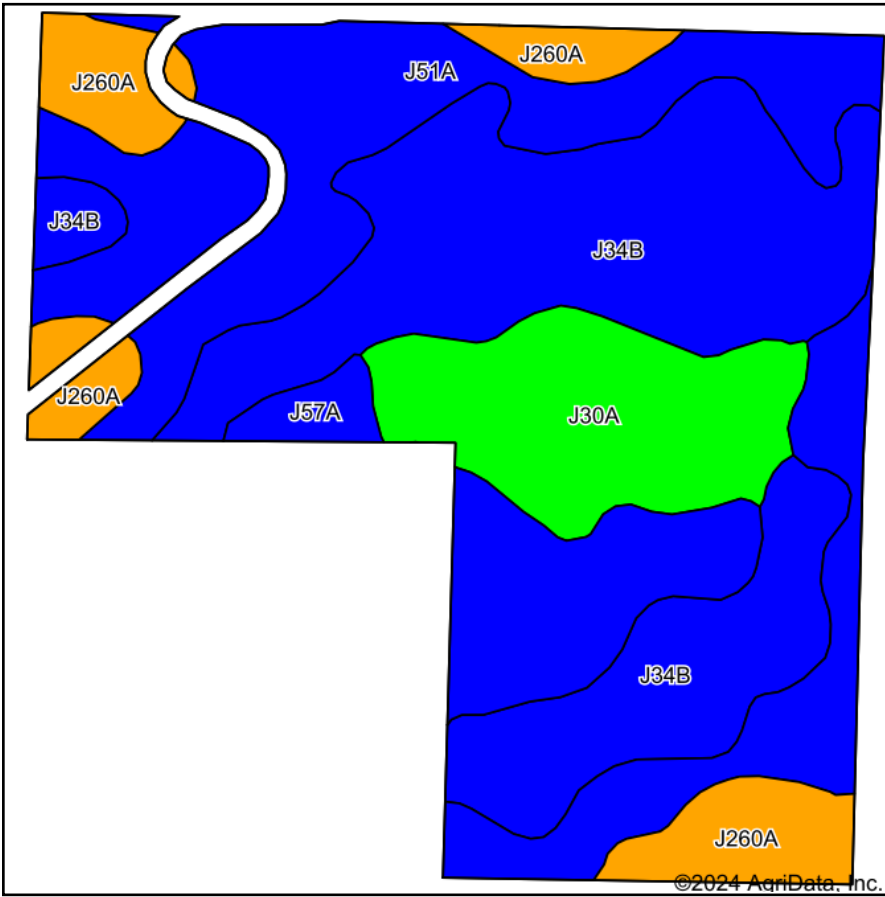

Soils data provided by USDA and NRCS.

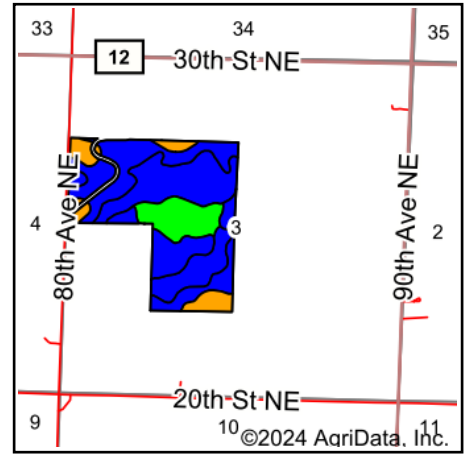

State: **Minnesota**  
 County: **Chippewa**  
 Location: **3-118N-38W**  
 Township: **Crate**  
 Acres: **114.89**  
 Date: **5/3/2024**



Maps Provided By:



© AgriData, Inc. 2023

www.AgriDataInc.com



Area Symbol: MN023, Soil Area Version: 26

Code	Soil Description	Acres	Percent of field	Non-Irr Class Legend	Non-Irr Class *c	*n NCCPI Overall	*n NCCPI Corn	*n NCCPI Soybeans
J51A	Bearden-Quam, depressional, complex, 0 to 2 percent slopes	45.38	39.5%		Ils	74	61	74
J34B	Byrne-Buse complex, 2 to 6 percent slopes	41.01	35.7%		Ile	66	57	66
J30A	Tara silt loam, 1 to 3 percent slopes	14.95	13.0%		le	78	64	78
J260A	Colvin-Quam complex, depressional, 0 to 1 percent slopes	11.73	10.2%		Illw	72	61	72
J57A	Balaton-Hamerly complex, 1 to 4 percent slopes	1.82	1.6%		Ils	71	58	71
<b>Weighted Average</b>					<b>1.97</b>	<b>*n 71.4</b>	<b>*n 59.9</b>	<b>*n 71.4</b>

\*n: The aggregation method is "Weighted Average using all components"

\*c: Using Capabilities Class Dominant Condition Aggregation Method