

Soils Map

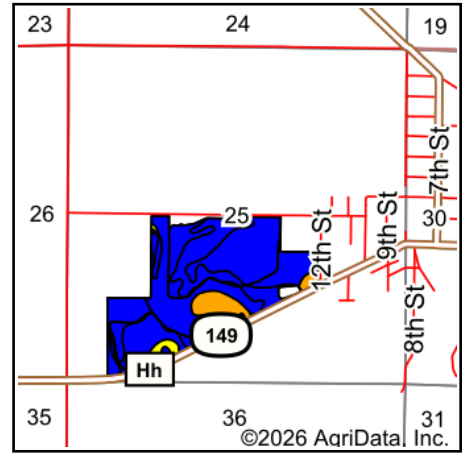

State: **Wisconsin**
 County: **Calumet**
 Location: **25-17N-20E**
 Township: **New Holstein**
 Acres: **114.08**
 Date: **4/2/2026**

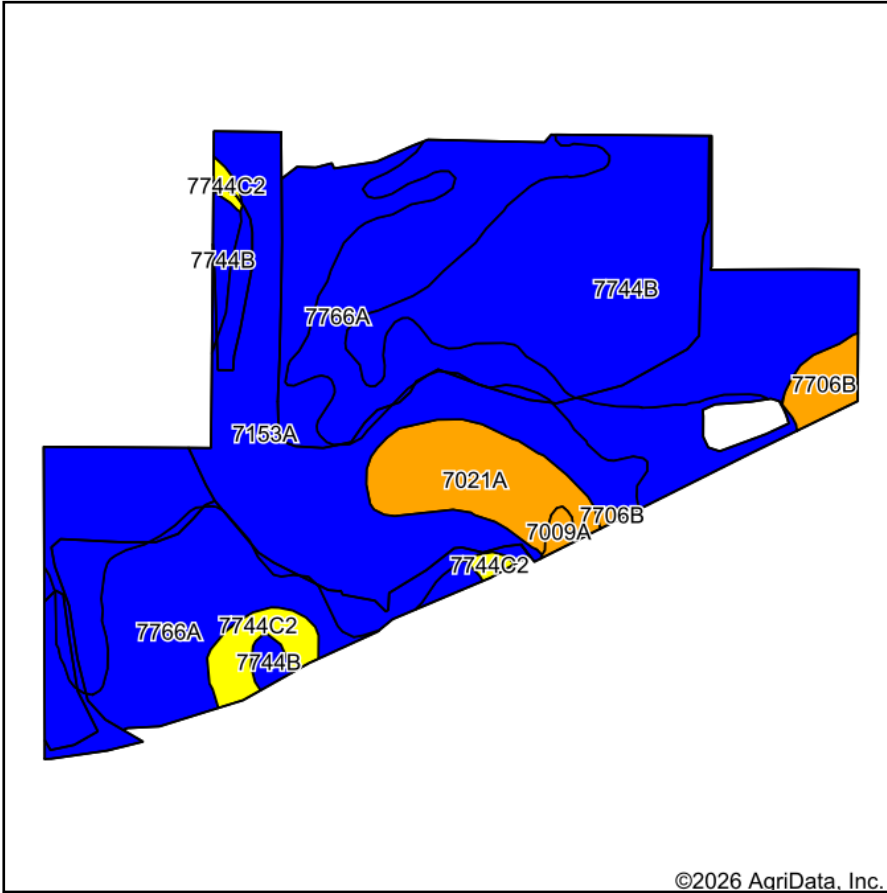

WEISS REALTY
 RENTING & FARM LAND PROPERTIES

Maps Provided By:



© AgriData, Inc. 2025

www.AgriDataInc.com



Soils data provided by USDA and NRCS.

©2026 AgriData, Inc.

Area Symbol: WI015, Soil Area Version: 4

Code	Soil Description	Acres	Percent of field	Non-Irr Class Legend	Non-Irr Class *c	*n NCCPI Overall
7153A	Pella silt loam, 0 to 2 percent slopes	38.98	34.2%		IIw	72
7766A	Lamartine silt loam, 0 to 3 percent slopes	32.25	28.3%		IIw	77
7744B	Hochheim loam, 2 to 6 percent slopes	30.67	26.9%		Ile	52
7021A	Palms muck, 0 to 2 percent slopes	6.99	6.1%		IIIw	33
7744C2	Hochheim loam, 6 to 12 percent slopes, eroded	2.86	2.5%		IVe	40
7706B	Boyer sandy loam, 2 to 6 percent slopes	1.95	1.7%		IIIs	46
7009A	Houghton muck, 0 to 2 percent slopes	0.38	0.3%		IIIw	11
Weighted Average					2.13	*n 64.2

*n: The aggregation method is "Weighted Average using all components"

*c: Using Capabilities Class Dominant Condition Aggregation Method

Soils data provided by USDA and NRCS.