



DISCLOSURE OF INFORMATION ON LEAD-BASED PAINT AND/OR LEAD-BASED PAINT HAZARDS

REO Case #:

Property Address: 10267 Ferry Point PL NW, Rice, MN 56367

Lead Warning Statement

House Built 1986/1987

Every purchaser of any interest in residential real property on which a residential dwelling was built prior to 1978 is notified that such property may present exposure to lead from lead-based paint that may place young children at risk of developing lead poisoning. Lead poisoning in young children may produce permanent neurological damage, including learning disabilities, reduced intelligence quotient, behavioral problems, and impaired memory. Lead poisoning also poses a particular risk to pregnant women. The seller of any interest in residential real property is required to provide the buyer with any information on lead-based paint hazards from risk assessments or inspections in the seller's possession and notify the buyer of any known lead-based paint hazards. A risk assessment or inspection for possible lead-based paint hazards is recommended prior to purchase, at purchaser's expense.

Seller's Disclosure

(a) Presence of lead-based paint and/or lead-based paint hazards (check (i) or (ii) below):

☐ (i) Known lead-based paint and/or lead-based paint hazards are present in the housing (explain):

☐ (ii) Seller has no knowledge of lead-based paint and/or lead-based paint hazards in the housing.

(b) Records and reports available to the seller (check (i) or (ii) one below):

☐ (i) Seller has provided the purchaser with all available records and reports pertaining to lead-based paint and/or lead-based paint hazards in the housing (list documents below).

☐ (ii) Seller has no reports or records pertaining to lead-based paint and/or lead-based paint hazards in the housing.

Purchaser's Acknowledgement (initial)

(c) _____ Purchaser has received copies of all information listed above.

(d) _____ Purchaser has received the pamphlet **Protect Your Family from Lead in Your Home**.

(e) Purchaser has (check (i) or (ii) below):

- ☐ (i) Received a 10-day opportunity (or mutually agreed upon period) to conduct a risk assessment or inspection for the presence of lead-based paint and/or lead-based paint hazards; or
- ☐ (ii) Waived the opportunity to conduct a risk assessment or inspection for the presence of lead-based paint and/or lead-based paint hazards.

PURCHASER AGREES THEY ARE PURCHASING THE PROPERTY "AS IS," WITHOUT ANY REPRESENTATIONS OR WARRANTIES WHATSOEVER AS TO THE CONDITION OF THE PROPERTY. PURCHASER FURTHER AGREES THAT SELLER AND ITS SERVICERS, REPRESENTATIVES, AGENTS, ATTORNEYS, OFFICERS, DIRECTORS, EMPLOYEES, SUCCESSORS AND ASSIGNS HAS NO RESPONSIBILITY OR LIABILITY FOR, AND PURCHASER HEREBY UNCONDITIONALLY RELEASES SELLER AND ITS SERVICERS, REPRESENTATIVES, AGENTS, ATTORNEYS, OFFICERS, DIRECTORS, EMPLOYEES, SUCCESSORS AND ASSIGNS FROM, ANY AND ALL LIABILITY, BOTH KNOWN AND UNKNOWN, PRESENT AND FUTURE, THAT IS BASED UPON, OR RELATED TO, THE EXISTENCE OF LEAD OR LEAD-BASED PAINT ON OR ABOUT THE PROPERTY.

Listing Agent's Acknowledgment (initial)

(f) Broker/Agent has informed the seller of the seller's obligations under 42 U.S.C. 4852d and is aware of his/her responsibility to ensure compliance.

Certification of Accuracy

The following parties have reviewed the information above and certify, to the best of their knowledge, that the information provided by the signatory is true and accurate.

Seller

Date

Purchaser

Date

Seller

Date

Purchaser

Date

Listing Agent

Date

Broker/Agent

Date



DISCLOSURE STATEMENT: LOCATION MAP

This form approved by the Minnesota Association of REALTORS®, which disclaims any liability arising out of use or misuse of this form.
© 2021 Minnesota Association of REALTORS®

2. Please use the space below to sketch the real property being sold and, to Seller's knowledge, the approximate location of any of the following on the property.
- 3.
4. ☐ SUBSURFACE SEWAGE TREATMENT SYSTEM ☐ WELL ☐ METHAMPHETAMINE PRODUCTION AREA
(Check all that apply.)
5. Include approximate distances from fixed reference points such as streets, buildings and landmarks.
6. Property located at 10267 Ferry Point PL NW, Rice, MN 56367
- 7.

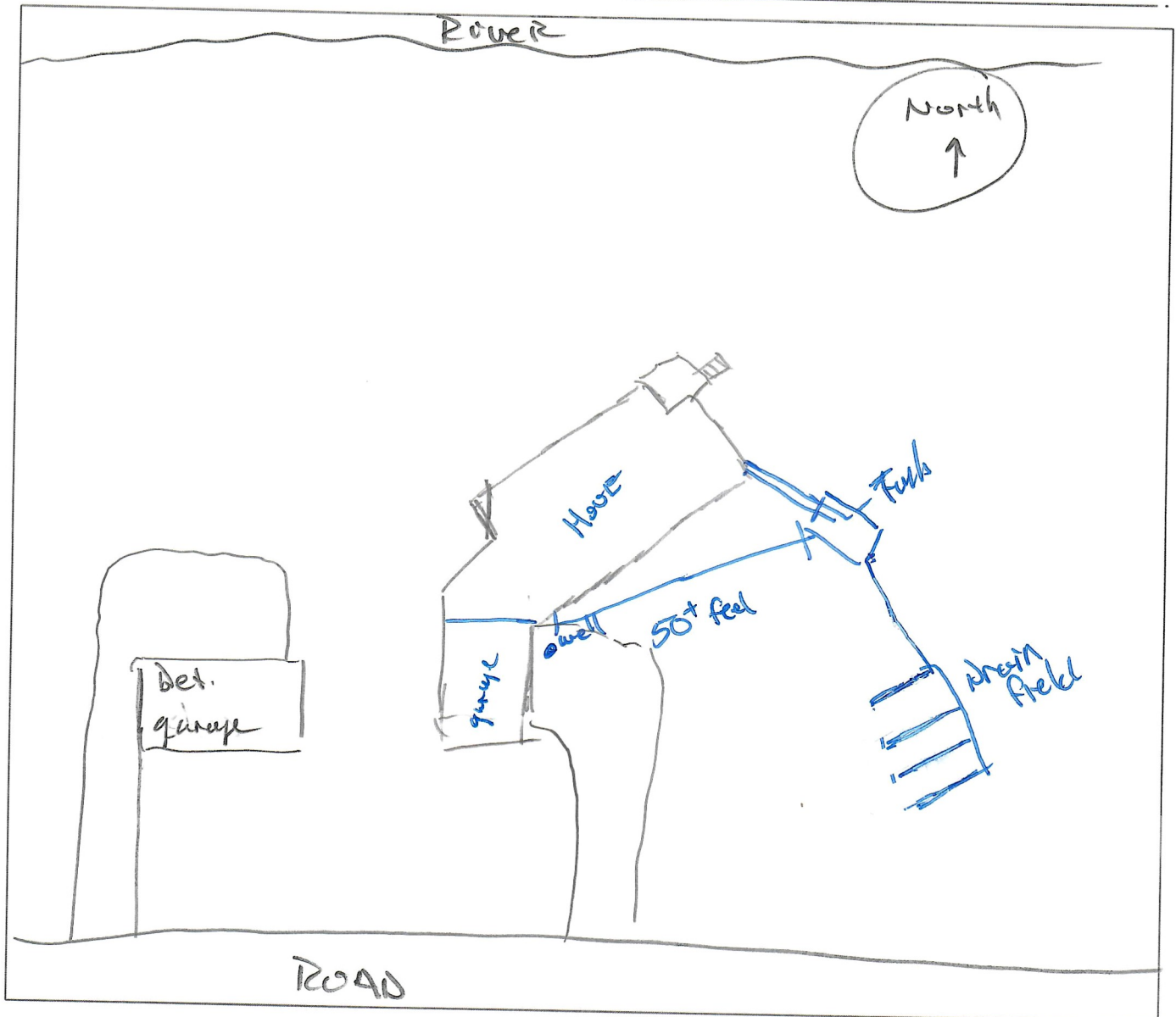

8. ATTACH ADDITIONAL SHEETS AS NEEDED.
9. Seller and Buyer initial: _____
(Seller) (Date) (Buyer) (Date)
10. _____
(Seller) (Date) (Buyer) (Date)

11. ORIGINAL COPY TO LISTING BROKER; COPIES TO SELLER, BUYER, SELLING BROKER

MN-IM (8/21)





DISCLOSURE STATEMENT: WELL

This form approved by the Minnesota Association of REALTORS®, which disclaims any liability arising out of use or misuse of this form.
© 2022 Minnesota Association of REALTORS®

1. Date 5-29-2025
2. Page 1 of _____ pages: THE REQUIRED MAP
3. IS ATTACHED HERE AND MADE A PART OF THIS
4. DISCLOSURE

5. Minnesota Statute 103I.235 requires that, before signing an agreement to sell or transfer real property, Seller must
6. disclose information in writing to Buyer about the status and location of all known wells on the property. This requirement
7. is satisfied by delivering to Buyer either a statement by Seller that Seller does not know of any wells on the property,
8. or a disclosure statement indicating the legal description and county, and a map showing the location of each well.
9. In the disclosure statement Seller must indicate, for each well, whether the well is in use, not in use or sealed.

10. Unless Buyer and Seller agree to the contrary in writing, before the closing of the sale, a Seller who fails to disclose
11. the existence or known status of a well at the time of sale, and knew or had reason to know of the existence or known
12. status of the well, is liable to Buyer for costs relating to sealing of the well and reasonable attorneys' fees for collection
13. of costs from Seller, if the action is commenced within six years after the date Buyer closed the purchase of the real
14. property where the well is located.

15. Legal requirements exist relating to various aspects of location and status of wells. Buyer is advised to
16. contact the local unit(s) of government, state agency, or qualified professional which regulates wells for further
17. information about these issues. For additional information on wells, please visit the Minnesota Department of Health's
18. website at www.health.state.mn.us.

19. Instructions for completion of this form are on page three (3).

20. **PROPERTY DESCRIPTION:** Street Address: 10267 Ferry Point PL NW,
21. City of Rice, County of Benton,
22. State of Minnesota, Zip Code 56367.

23. **LEGAL DESCRIPTION:** _____
24. _____
25. _____ ("Property").

26. WELL DISCLOSURE STATEMENT: (Check appropriate boxes.)

27. Seller certifies that the following wells are located on the above-described real Property.

	MN Unique Well No.	Well Depth	Year of Const.	Well Type	IN USE	NOT IN USE	SHARED	SEALED
28. Well 1	_____	_____	_____	_____	<input type="checkbox"/>	<input type="checkbox"/>	<input type="checkbox"/>	<input type="checkbox"/>
29. Well 2	_____	_____	_____	_____	<input type="checkbox"/>	<input type="checkbox"/>	<input type="checkbox"/>	<input type="checkbox"/>
30. Well 3	_____	_____	_____	_____	<input type="checkbox"/>	<input type="checkbox"/>	<input type="checkbox"/>	<input type="checkbox"/>

31. Is this property served by a well not located on the Property?
32. If "Yes," please explain: _____
33. ☐ Yes ☒ No

34. **NOTE:** See definition of terms "IN USE," "NOT IN USE," and "SEALED" on lines 87-97. If a well is not in use, it
35. must be sealed by a licensed well contractor or a well owner must obtain a maintenance permit from
36. the Minnesota Department of Health and pay an annual maintenance fee. Maintenance permits are not
37. transferable. If a well is operable and properly maintained, a maintenance permit is not required.

38. If the well is, "Shared":
39. (1) How many properties or residences does the shared well serve? _____
40. (2) Who manages the shared well? _____
41. (3) Is there a maintenance agreement for the shared well? ☐ Yes ☐ No
42. If "Yes," what is the annual maintenance fee? \$ _____

DISCLOSURE STATEMENT: WELL

45. Page 2

46. Property located at 10267 Ferry Point PL NW, Rice, MN 56367

47. OTHER WELL INFORMATION:

48. Date well water last tested for contaminants: Dec 2023 Test results attached? ☐ Yes ☒ No

49. Contaminated Well: Is there a well on the Property containing contaminated water? ☐ Yes ☐ No

50. Comments: well test failed on one item. Trust wells involved
51. new system to sample lake water

52. _____

53. _____

54. _____

55. _____

56. _____

57. SEALED WELL INFORMATION: For each well designated as sealed above, complete this section.

58. When was the well sealed? _____

59. Who sealed the well? _____

60. Was a Sealed Well Report filed with the Minnesota Department of Health? ☐ Yes ☐ No

61. **MAP: Complete the attached *Disclosure Statement: Location Map* showing the location of each well on the**
62. **real Property.**

63. This disclosure is not a warranty of any kind by Seller(s) or any licensee(s) representing or assisting any part/(ies) in
64. this transaction and is not a substitute for any inspections or warranties the party(ies) may wish to obtain.

65. INSTRUCTIONS FOR COMPLETING THE WELL DISCLOSURE STATEMENT

66. **DEFINITION:** A "well" means an excavation that is drilled, cored, bored, washed, driven, dug, jetted, or otherwise
67. constructed if the excavation is intended for the location, diversion, artificial recharge, or acquisition of groundwater.

68. **MINNESOTA UNIQUE WELL NUMBER:** All new wells constructed AFTER January 1, 1975, should have been
69. assigned a Minnesota unique well number by the person constructing the well. If the well was constructed after this
70. date, you should have the unique well number in your property records. If you are unable to locate your unique well
71. number and the well was constructed AFTER January 1, 1975, contact your well contractor. If no unique well number
72. is available, please indicate the depth and year of construction for each well.

73. **WELL TYPE:** Use one of the following terms to describe the well type.

74. **WATER WELL:** A water well is any type of well used to extract groundwater for private or public use.
75. Examples of water wells are: domestic wells, drive-point wells, dug wells, remedial wells, and municipal
76. wells.

77. **IRRIGATION WELL:** An irrigation well is a well used to irrigate agricultural lands. These are typically
78. large-diameter wells connected to a large pressure distribution system.

79. **MONITORING WELL:** A monitoring well is a well used to monitor groundwater contamination. The well is
80. typically used to access groundwater for the extraction of samples.

81. **DEWATERING WELL:** A dewatering well is a well used to lower groundwater levels to allow for construction
82. or use of underground spaces.

83. **INDUSTRIAL/COMMERCIAL WELL:** An industrial/commercial well is a nonpotable well used to extract
84. groundwater for any nonpotable use, including groundwater thermal exchange wells (heat pumps and heat
85. loops).

DISCLOSURE STATEMENT: WELL

86. Page 3

87. **WELL USE STATUS:** Indicate the use status of each well. CHECK ONLY ONE (1) BOX PER WELL.

88. **IN USE:** A well is "in use" if the well is operated on a daily, regular, or seasonal basis. A well in use includes
89. a well that operates for the purpose of irrigation, fire protection, or emergency pumping.

90. **NOT IN USE:** A well is "not in use" if the well does not meet the definition of "in use" above and has not
91. been sealed by a licensed well contractor.

92. **SEALED:** A well is "sealed" if a licensed contractor has completely filled a well by pumping grout material
93. throughout the entire bore hole after removal of any obstructions from the well. A well is "capped" if it has
94. a metal or plastic cap or cover which is threaded, bolted or welded into the top of the well to prevent entry
95. into the well. A "capped" well is not a "sealed" well.

96. If the well has been sealed by someone other than a licensed well contractor or a licensed well sealing
97. contractor, check the well status as "not in use."

98. If you have any questions, please contact the Minnesota Department of Health, Well Management Section,
99. at (651) 201-4587 (metropolitan Minneapolis-St. Paul) or 1-800-383-9808 (greater Minnesota).

100. **SELLER'S STATEMENT:** *(To be signed at time of listing.)*

101. Seller(s) hereby states that the facts as stated above are true and accurate and authorizes any licensee(s) representing
102. or assisting any party(ies) in this transaction to provide a copy of this Disclosure Statement to any person or entity
103. in connection with any actual or anticipated sale of the Property. A seller may provide this Disclosure Statement to
104. a real estate licensee representing or assisting a prospective buyer. The Disclosure Statement provided to the real
105. estate licensee representing or assisting a prospective buyer is considered to have been provided to the prospective
106. buyer. If this Disclosure Statement is provided to the real estate licensee representing or assisting the prospective
107. buyer, the real estate licensee must provide a copy to the prospective buyer.

108. **Seller is obligated to continue to notify Buyer in writing of any facts that differ from the facts disclosed here**
109. **(new or changed) of which Seller is aware that could adversely and significantly affect the Buyer's use or**
110. **enjoyment of the Property or any intended use of the Property that occur up to the time of closing. To disclose**
111. **new or changed facts, please use the Amendment to Disclosure Statement form.**

112.  5-28-2025  5-28-2025
(Seller) (Date) (Seller) (Date)

113. **BUYER'S ACKNOWLEDGEMENT:** *(To be signed at time of purchase agreement.)*

114. I/We, the Buyer(s) of the Property, acknowledge receipt of this *Disclosure Statement: Well* and *Disclosure Statement:*
115. *Location Map* and agree that no representations regarding facts have been made other than those made above.

116. _____
(Buyer, (Date) (Buyer) (Date)

117. **LISTING BROKER AND LICENSEES MAKE NO REPRESENTATIONS HERE AND ARE**
118. **NOT RESPONSIBLE FOR ANY CONDITIONS EXISTING ON THE PROPERTY.**

MN-DS:W-3 (8/22)



DISCLOSURE STATEMENT: SUBSURFACE SEWAGE TREATMENT SYSTEM

This form approved by the Minnesota Association of REALTORS®, which disclaims any liability arising out of use or misuse of this form.
© 2021 Minnesota Association of REALTORS®

1. Date 5-29-25
2. Page 1 of _____ pages:
3. THE REQUIRED MAP IS ATTACHED AND MADE A
4. PART OF THIS DISCLOSURE

5. Property located at 10267 Ferry Point PL NW
6. City of Rice, County of Benton
7. State of Minnesota, Zip Code 56367, legally described as follows or on attached sheet:

8. _____ ("Property").
9. This disclosure is not a warranty of any kind by Seller(s) or any licensee(s) representing or assisting any party(ies) in
10. this transaction, and is not a substitute for any inspections or warranties the party(ies) may wish to obtain.

11. **BUYER(S) AND SELLER(S) MAY WISH TO OBTAIN PROFESSIONAL ADVICE AND/OR INSPECTIONS OF THE**
12. **SUBSURFACE SEWAGE TREATMENT SYSTEM AND TO PROVIDE FOR APPROPRIATE PROVISIONS IN A**
13. **CONTRACT BETWEEN BUYER(S) AND SELLER(S) WITH RESPECT TO ANY ADVICE/INSPECTION/**
14. **DEFECTS.**

15. **SELLER'S INFORMATION:** The following Seller disclosure satisfies MN Statutes Chapter 115.55. Seller discloses
16. the following information with the knowledge that even though this is not a warranty, prospective Buyers may rely on
17. this information in deciding whether and on what terms to purchase the Property. The Seller(s) authorizes any
18. licensee(s) representing or assisting any party(ies) in this transaction to provide a copy of this statement to any person
19. or entity in connection with any actual or anticipated sale of the Property.

20. Unless Buyer and Seller agree to the contrary in writing before the closing of the sale, a Seller who fails to disclose
21. the existence or known status of a subsurface sewage treatment system at the time of sale, and who knew or had
22. reason to know of the existence or known status of the system, is liable to Buyer for costs relating to bringing the
23. system into compliance with subsurface sewage treatment system rules and for reasonable attorney fees for collection
24. of costs from Seller. An action under this subdivision must be commenced within two years after the date on which
25. Buyer closed the purchase of the real property where the system is located.

26. Legal requirements exist relating to various aspects of location and status of subsurface sewage treatment systems.
27. Buyer is advised to contact the local unit(s) of government, state agency, or qualified professional which regulates
28. subsurface sewage treatment systems for further information about these issues.

29. The following are representations made by Seller(s) to the extent of Seller(s) actual knowledge. This information is a
30. disclosure and is not intended to be part of any contract between Buyer and Seller.

31. **SUBSURFACE SEWAGE TREATMENT SYSTEM DISCLOSURE:** (Check the appropriate boxes.)

32. Seller certifies that the following subsurface sewage treatment system is on or serving the above-described Property.

33. TYPE: (Check appropriate box(es) and indicate location on attached Disclosure Statement: Location Map.)

34. ☒ Septic Tank: ☒ with drain field ☐ with mound system ☐ seepage tank ☐ with open end

35. Is this system a straight-pipe system? ☐ Yes ☐ No ☐ Unknown

36. ☐ Sealed System (holding tank)

37. ☐ Other (Describe.): _____

38. Is the subsurface sewage treatment system(s) currently in use? ☒ Yes ☐ No

39. Is the above-described Property served by a subsurface sewage treatment system
40. located entirely within the Property boundary lines, including setback requirements? ☒ Yes ☐ No

41. If "No," please explain: _____

42. _____

43. Comments: _____

44. _____

DISCLOSURE STATEMENT: SUBSURFACE
SEWAGE TREATMENT SYSTEM

45. Page 2

46. Property located at 10267 Ferry Point PL NW, Rice MN 56367
47. Is the subsurface sewage treatment system(s) a shared system? ☐ Yes ☒ No
48. If "Yes,"
49. (1) How many properties or residences does the subsurface sewage treatment system serve?
50. 1
51. (2) Is there a maintenance agreement for the shared subsurface sewage treatment system? ☐ Yes ☐ No
52. If "Yes," what is the annual maintenance fee? \$ _____
53. **NOTE:** If any water use appliance, bedroom, or bathroom has been added to the Property, the system may
54. no longer comply with applicable sewage treatment system laws and rules.
55. Seller or transferor shall disclose to Buyer or transferee what Seller or transferor has knowledge of relative to the
56. compliance status of the subsurface sewage treatment system. _____
57. _____
58. _____
59. Any previous inspection report in Seller's possession must be attached to this Disclosure Statement.
60. When was the subsurface sewage treatment system installed? _____
61. Installer Name/Phone _____
62. Where is tank located? See Drawing
63. What is tank size? See PDF
64. When was tank last pumped? 2024
65. How often is tank pumped? once / yr
66. Where is the drain field located? See MAP
67. What is the drain field size? u u
68. Describe work performed to the subsurface sewage treatment system since you have owned the Property.
69. _____
70. _____
71. Date work performed/by whom: _____
72. _____
73. Approximate number of:
74. people using the subsurface sewage treatment system 6
75. showers/baths taken per week 20+
76. wash loads per week 20+
77. **NOTE:** Changes in the number of people using the subsurface sewage treatment system or volume of water
78. used may affect the subsurface sewage treatment system performance.
79. Distance between well and subsurface sewage treatment system? 50+ feet
80. Have you received any notices from any government agencies relating to the subsurface sewage treatment system?
81. (If "Yes," see attached notice.) ☐ Yes ☒ No
82. Are there any known defects in the subsurface sewage treatment system? ☐ Yes ☒ No
83. If "Yes," please explain: _____
84. _____
85. _____

DISCLOSURE STATEMENT: SUBSURFACE
SEWAGE TREATMENT SYSTEM

86. Page 3

87. Property located at 10267 Ferry Point PL NW, Rice, MN 56367

88. **SELLER'S STATEMENT:** *(To be signed at time of listing.)*

89. Seller(s) hereby states the facts as stated above are true and accurate and authorizes any licensee(s) representing or
90. assisting any party(ies) in this transaction to provide a copy of this Disclosure Statement to any person or entity in
91. connection with any actual or anticipated sale of the Property. A seller may provide this Disclosure Statement to a
92. real estate licensee representing or assisting a prospective buyer. The Disclosure Statement provided to the real
93. estate licensee representing or assisting a prospective buyer is considered to have been provided to the prospective
94. buyer. If this Disclosure Statement is provided to the real estate licensee representing or assisting the prospective
95. buyer, the real estate licensee must provide a copy to the prospective buyer.

96. **Seller is obligated to continue to notify Buyer in writing of any facts that differ from the facts disclosed here**
97. **(new or changed) of which Seller is aware that could adversely and significantly affect the Buyer's use or**
98. **enjoyment of the Property or any intended use of the Property that occur up to the time of closing. To disclose**
99. **new or changed facts, please use the Amendment to Disclosure Statement form.**

100.  5-28-2025  5-28-2025
(Seller) (Date) (Seller) (Date)

101. **BUYER'S ACKNOWLEDGEMENT:** *(To be signed at time of purchase agreement.)*

102. I/We, the Buyer(s) of the Property, acknowledge receipt of this *Disclosure Statement: Subsurface Sewage Treatment*
103. *System and Disclosure Statement: Location Map* and agree that no representations regarding facts have been made
104. other than those made above.

105. _____
(Buyer) (Date) (Buyer) (Date)

106. **LISTING BROKER AND LICENSEES MAKE NO REPRESENTATIONS HERE AND ARE**
107. **NOT RESPONSIBLE FOR ANY CONDITIONS EXISTING ON THE PROPERTY.**

MN-DS:SSTS-3 (8/21)