

Compliance inspection report form

Existing Subsurface Sewage Treatment System (SSTS)

Doc Type: Compliance and Enforcement

Instructions: Inspector must submit completed form to Local Governmental Unit (LGU) and system owner within 15 days of final determination of compliance or noncompliance. Instructions for filling out this form are located on the Minnesota Pollution Control Agency (MPCA) website at <https://www.pca.state.mn.us/sites/default/files/wq-wwists4-31a.pdf>.

Property information

Parcel ID# or Sec/Twp/Range: 16.24.02300 Local tracking number: _____
Local regulatory authority info: Hubbard Co Reason for Inspection _____
Property address: 20745 Harmony Rd _____
Owner/representative: John & Amy Mondloch Owner's phone: _____
Brief system description: 1500gal Holding tank _____

System status

System status on date (mm/dd/yyyy): 7/28/2023

☒ **Compliant – Certificate of compliance***

(Valid for 3 years from report date unless evidence of an imminent threat to public health or safety requiring removal and abatement under section 145A.04, subdivision 8 is discovered or a shorter time frame exists in Local Ordinance.)

*Note: Compliance indicates conformance with Minn. R. 7080.1500 as of system status date above and does not guarantee future performance.

☐ **Noncompliant – Notice of noncompliance**

Systems failing to protect ground water must be upgraded, replaced, or use discontinued within the time required by local ordinance.

An imminent threat to public health and safety (ITPHS) must be upgraded, replaced, or its use discontinued within ten months of receipt of this notice or within a shorter period if required by local ordinance or under section 145A.04 subdivision 8.

Reason(s) for noncompliance (check all applicable)

- ☐ Impact on public health (Compliance component #1) – Imminent threat to public health and safety
- ☐ Tank integrity (Compliance component #2) – Failing to protect groundwater
- ☐ Other Compliance Conditions (Compliance component #3) – Imminent threat to public health and safety
- ☐ Other Compliance Conditions (Compliance component #3) – Failing to protect groundwater
- ☐ System not abandoned according to Minn. R. 7080.2500 (Compliance component #3) – Failing to protect groundwater
- ☐ Soil separation (Compliance component #5) – Failing to protect groundwater
- ☐ Operating permit/monitoring plan requirements (Compliance component #4) – Noncompliant - local ordinance applies

Comments or recommendations

Certification

I hereby certify that all the necessary information has been gathered to determine the compliance status of this system. No determination of future system performance has been nor can be made due to unknown conditions during system construction, possible abuse of the system, inadequate maintenance, or future water usage.

By typing my name below, I certify the above statements to be true and correct, to the best of my knowledge, and that this information can be used for the purpose of processing this form.

Business name: Don Umthun

Inspector signature: 

Certification number: 4549

License number: 1867

Phone: 218-252-6411

(This document has been electronically signed)

Necessary or locally required supporting documentation (must be attached)

- ☐ Soil observation logs ☒ System/As-Built ☐ Locally required forms ☒ Tank Integrity Assessment ☐ Operating Permit
- ☐ Other information (list): _____

1. Impact on public health – Compliance component #1 of 5

Compliance criteria:

System discharges sewage to the ground surface

☐ Yes* ☒ No

System discharges sewage to drain tile or surface waters.

☐ Yes* ☒ No

System causes sewage backup into dwelling or establishment.

☐ Yes* ☒ No

Any "yes" answer above indicates the system is an imminent threat to public health and safety.

Describe verification methods and results:

Attached supporting documentation:

☐ Other:

☐ Not applicable

2. Tank integrity – Compliance component #2 of 5

Compliance criteria:

System consists of a seepage pit, cesspool, drywell, leaching pit, or other pit?

☐ Yes* ☒ No

Sewage tank(s) leak below their designed operating depth?

☐ Yes* ☒ No

If yes, which sewage tank(s) leaks:

Any "yes" answer above indicates the system is failing to protect groundwater.

Describe verification methods and results:

Attached supporting documentation:

☒ Empty tank(s) viewed by inspector

Name of maintenance business: Potty Shack

License number of maintenance business: 3268

Date of maintenance: 7/28/2023

☐ Existing tank integrity assessment (Attach)

Date of maintenance (mm/dd/yyyy): (must be within three years)

(See form instructions to ensure assessment complies with Minn. R. 7082.0700 subp. 4 B (1))

☐ Tank is Noncompliant (pumping not necessary – explain below)

☐ Other:

Property Address: 20745 Harmony Rd
Business Name: Don Umthun

Date: 7/28/2023

1. Impact on public health – Compliance component #1 of 5

Compliance criteria:

System discharges sewage to the ground surface

☐ Yes* ☒ No

System discharges sewage to drain tile or surface waters.

☐ Yes* ☒ No

System causes sewage backup into dwelling or establishment.

☐ Yes* ☒ No

Any "yes" answer above indicates the system is an imminent threat to public health and safety.

Describe verification methods and results:

Attached supporting documentation:

☐ Other:

☐ Not applicable

2. Tank integrity – Compliance component #2 of 5

Compliance criteria:

System consists of a seepage pit, cesspool, drywell, leaching pit, or other pit?

☐ Yes* ☒ No

Sewage tank(s) leak below their designed operating depth?

☐ Yes* ☒ No

If yes, which sewage tank(s) leaks:

Any "yes" answer above indicates the system is failing to protect groundwater.

Describe verification methods and results:

Attached supporting documentation:

☒ Empty tank(s) viewed by inspector

Name of maintenance business: Potty Shack

License number of maintenance business: 3268

Date of maintenance: 7/28/2023

☐ Existing tank integrity assessment (Attach)

Date of maintenance (mm/dd/yyyy):

(must be within three years)

(See form instructions to ensure assessment complies with Minn. R. 7082.0700 subp. 4 B (1))

☐ Tank is Noncompliant (pumping not necessary – explain below)

☐ Other:

Property Address: 20745 Harmony Rd
Business Name: Don Umthun

Date: 7/28/2023

3. Other compliance conditions – Compliance component #3 of 5

3a. Maintenance hole covers appear to be structurally unsound (damaged, cracked, etc.), or unsecured?

☐ Yes* ☒ No ☐ Unknown

3b. Other issues (electrical hazards, etc.) to immediately and adversely impact public health or safety? ☐ Yes* ☒ No ☐ Unknown

**Yes to 3a or 3b - System is an imminent threat to public health and safety.*

3c. System is non-protective of ground water for other conditions as determined by inspector?

☐ Yes* ☒ No

3d. System not abandoned in accordance with Minn. R. 7080.2500?

☐ Yes* ☒ No

**Yes to 3c or 3d - System is failing to protect groundwater.*

Describe verification methods and results:

Attached supporting documentation: ☐ Not applicable ☐

4. Operating permit and nitrogen BMP* – Compliance component #4 of 5 ☒ Not applicable

Is the system operated under an Operating Permit?

☐ Yes ☐ No If "yes", A below is required

Is the system required to employ a Nitrogen BMP specified in the system design? ☐ Yes ☐ No If "yes", B below is required

BMP = Best Management Practice(s) specified in the system design

If the answer to both questions is "no", this section does not need to be completed.

Compliance criteria:

a. Have the operating permit requirements been met?

☐ Yes ☐ No

b. Is the required nitrogen BMP in place and properly functioning?

☐ Yes ☐ No

Any "no" answer indicates noncompliance.

Describe verification methods and results:

Attached supporting documentation: ☐ Operating permit (Attach) ☐

Property Address: 20745 Harmony Rd
Business Name: Don Umthun

Date: 7/28/2023

5. Soil separation – Compliance component #5 of 5

Date of installation 6/1/1997
(mm/dd/yyyy)

☐ Unknown

Shoreland/Wellhead protection/Food
beverage lodging?

☒ Yes ☐ No

Compliance criteria (select one):

5a. For systems built prior to April 1, 1996, and
not located in Shoreland or Wellhead
Protection Area or not serving a food,
beverage or lodging establishment:

☐ Yes ☐ No*

Drainfield has at least a two-foot vertical
separation distance from periodically
saturated soil or bedrock.

5b. Non-performance systems built
April 1, 1996, or later or for non-
performance systems located in Shoreland
or Wellhead Protection Areas or serving a
food, beverage, or lodging establishment:

☐ Yes ☐ No*

Drainfield has a three-foot vertical
separation distance from periodically
saturated soil or bedrock.*

5c. "Experimental", "Other", or "Performance"
systems built under pre-2008 Rules;
Type IV or V systems built under 2008
Rules 7080. 2350 or 7080. 2400
(Intermediate Inspector License required ≤
2,500 gallons per day; Advanced Inspector
License required > 2,500 gallons per day)

☐ Yes ☐ No*

Drainfield meets the designed vertical
separation distance from periodically
saturated soil or bedrock.

*Any "no" answer above indicates the system is
failing to protect groundwater.

Describe verification methods and results:

Attached supporting documentation:

- ☐ Soil observation logs completed for the report
☐ Two previous verifications of required vertical separation
☐ Not applicable (No soil treatment area)
☐

Indicate depths or elevations

A. Bottom of distribution media	
B. Periodically saturated soil/bedrock	
C. System separation	36+
D. Required compliance separation*	36

*May be reduced up to 15 percent if allowed by Local
Ordinance.

Upgrade requirements: (Minn. Stat. § 115.55) An imminent threat to public health and safety (ITPHS) must be upgraded, replaced, or its use discontinued within ten months of receipt of this notice or within a shorter period if required by local ordinance. If the system is failing to protect ground water, the system must be upgraded, replaced, or its use discontinued within the time required by local ordinance. If an existing system is not failing as defined in law, and has at least two feet of design soil separation, then the system need not be upgraded, repaired, replaced, or its use discontinued, notwithstanding any local ordinance that is more strict. This provision does not apply to systems in shoreland areas, Wellhead Protection Areas, or those used in connection with food, beverage, and lodging establishments as defined in law.

Property Address: 20745 Harmony Rd
Business Name: Don Umthun

Date: 7/28/2023

5. Soil separation – Compliance component #5 of 5

Date of installation 6/1/1997
(mm/dd/yyyy)

☐ Unknown

Shoreland/Wellhead protection/Food
beverage lodging?

☒ Yes ☐ No

Compliance criteria (select one):

5a. For systems built prior to April 1, 1996, and
not located in Shoreland or Wellhead
Protection Area or not serving a food,
beverage or lodging establishment:

☐ Yes ☐ No*

Drainfield has at least a two-foot vertical
separation distance from periodically
saturated soil or bedrock.

5b. Non-performance systems built
April 1, 1996, or later or for non-
performance systems located in Shoreland
or Wellhead Protection Areas or serving a
food, beverage, or lodging establishment:

☐ Yes ☐ No*

Drainfield has a three-foot vertical
separation distance from periodically
saturated soil or bedrock.*

5c. "Experimental", "Other", or "Performance"
systems built under pre-2008 Rules;
Type IV or V systems built under 2008
Rules 7080. 2350 or 7080.2400
(Intermediate Inspector License required ≤
2,500 gallons per day; Advanced Inspector
License required > 2,500 gallons per day)

☐ Yes ☐ No*

Drainfield meets the designed vertical
separation distance from periodically
saturated soil or bedrock.

*Any "no" answer above indicates the system is
failing to protect groundwater.

Describe verification methods and results:

Attached supporting documentation:

- ☐ Soil observation logs completed for the report
☐ Two previous verifications of required vertical separation
☐ Not applicable (No soil treatment area)
☐

Indicate depths or elevations

A. Bottom of distribution media	
B. Periodically saturated soil/bedrock	
C. System separation	36+
D. Required compliance separation*	36

*May be reduced up to 15 percent if allowed by Local
Ordinance.

Upgrade requirements: (Minn. Stat. § 115.55) An imminent threat to public health and safety (ITPHS) must be upgraded, replaced, or its use discontinued within ten months of receipt of this notice or within a shorter period if required by local ordinance. If the system is failing to protect ground water, the system must be upgraded, replaced, or its use discontinued within the time required by local ordinance. If an existing system is not failing as defined in law, and has at least two feet of design soil separation, then the system need not be upgraded, repaired, replaced, or its use discontinued, notwithstanding any local ordinance that is more strict. This provision does not apply to systems in shoreland areas, Wellhead Protection Areas, or those used in connection with food, beverage, and lodging establishments as defined in law.

Sewage tank integrity assessment form

Subsurface Sewage Treatment Systems (SSTS) Program

Purpose: This form may be used to certify the compliance status of the sewage tank components of the SSTS. This form is not a complete SSTS inspection report, only a tank integrity assessment, and may only certify sewage tank compliance status when entirely completed and signed by a qualified professional. SSTS compliance inspection report forms can be found at: <https://www.pca.state.mn.us/water/inspections>.

Instructions: This form may be completed, and signed, by a Designated Certified Individual (DCI) of a licensed SSTS inspection, maintenance, installation, or service provider business who personally conducts the necessary procedures to assess the compliance status of each sewage tank in the system. A copy of this information should be submitted to the system owner and be maintained by the licensed SSTS business for a period of five (5) years from the assessment date.

When this form is signed by a qualified certified professional, it becomes *necessary supporting documentation* to an Existing System Compliance Inspection Report: Compliance inspection form - Existing system (wq-wwists4-31b). This form can be found on the MPCA website at <https://www.pca.state.mn.us/water/inspections>.

The information and certified statement on this form is required when existing septic tank compliance status is determined by an individual other than the SSTS Inspector that submits an inspection report. This form represents a third party assessment of SSTS component compliance and is allowable under Minn. R. 7082.0700, subp. 4 Item (B) subitem (1). This form is valid for a period of three years beyond the signature date on this form unless a new evaluation is requested by the owner or owner's agent or is required according to local regulations. Additional Administrative Rule references for this activity can be found at Minn. R. 7082.0700, subp. 4 Items B, C, and D; 7083.0730 Item C.

☒ Certificate of sewage tank compliance

Affirm all three statements:

- ☒ The SSTS does not contain a seepage pit, cesspool, drywell, leaching pit, or other pit.
- ☒ It does not contain a sewage tank that was designed to be watertight, but subsequently leaks below the designed operating depth.
- ☒ It does not represent an imminent safety threat by reason of unsecured, damaged, or weak maintenance hole cover(s) or other unsafe condition.

☐ Notice of sewage tank non-compliance

Select all that apply:

- ☐ The SSTS has a seepage pit, cesspool, drywell, leaching pit, or other pit – "Failure to Protect Groundwater."
- ☐ It has a sewage tank that was designed to be watertight, but subsequently leaks below the designed operating depth – "Failure to Protect Groundwater."
- ☐ It presents a threat to public safety by reason of unsecured, damaged, or weak maintenance hole cover(s) or other unsafe condition – w/Imminent Threat to Public Health or Safety."

Company information

Company name: Don Umthun

Business license number: 1867

Designated Certified Individual (DCI) information

Print name: _____

Certification number: 4549

I personally conducted the work described above as a Designated Certified Individual of a Minnesota-licensed SSTS inspection, maintenance, installation, or service provider Business. I personally conducted the necessary procedures to assess the compliance status of each sewage tank in this SSTS.

By typing/signing my name below, I certify the above statements to be true and correct, to the best of my knowledge, and that this information can be used for the purpose of processing this form.

Designated Certified
Individual's signature:



(This document has been electronically signed.)

Date (mm/dd/yyyy): 7/28/2023

20745 Harmony Rd

SITE PLAN MUST BE DRAWN TO SCALE OR DIMENSION WITH NORTH ARROW.

Plan must include:

- * Lot Dimensions
- * Tank Access Route
- * Alternative Drainfield Site
- * Lot Easements
- * Wells Within 100 feet of System
- * Slope & Direction
- * All ISTS Components
- * Horizontal Setbacks
- * Existing & Proposed Buildings
- * Soil Borings
- * Disturbed/Compacted Areas

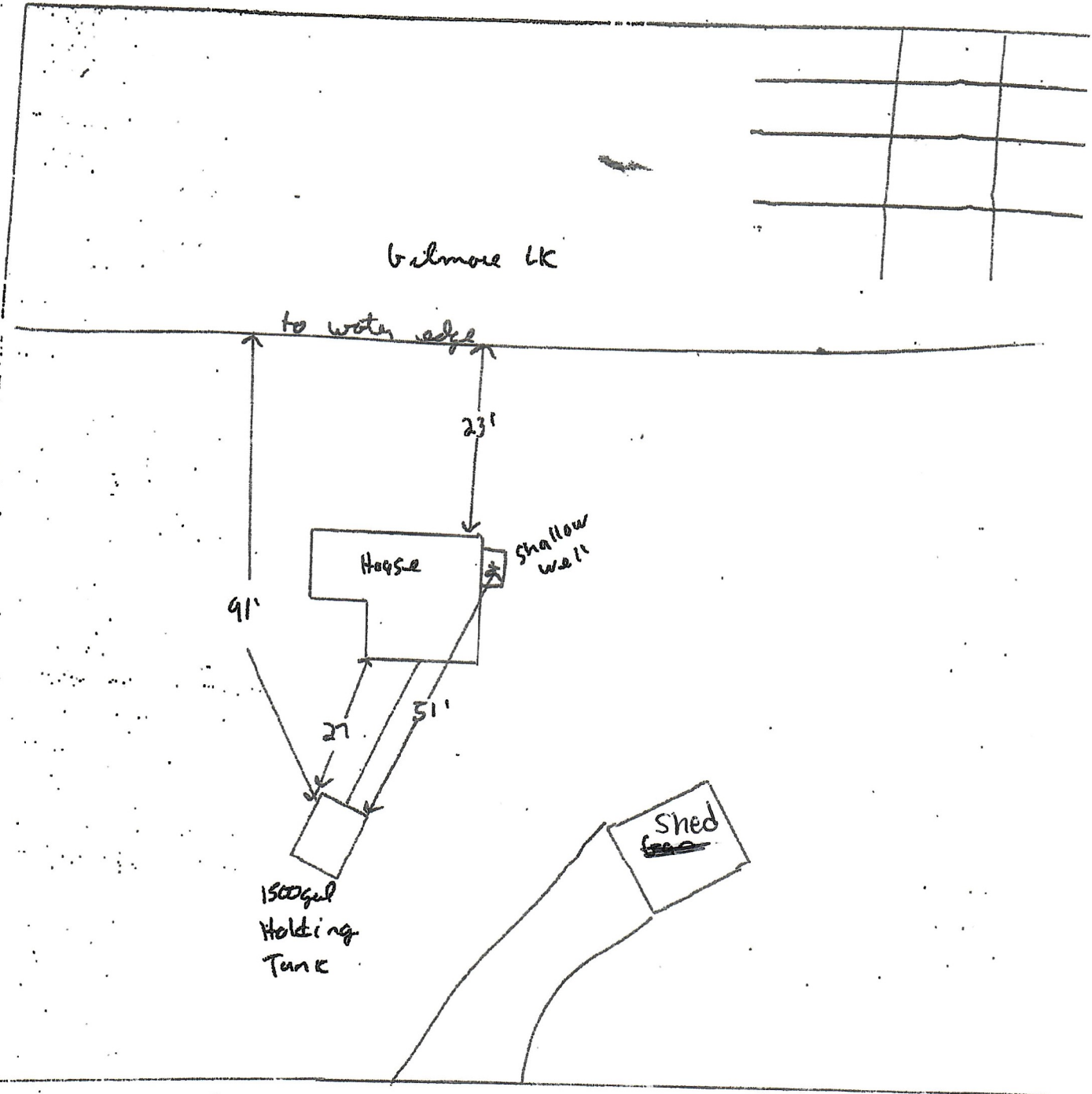

Harmony Rd

SEPTIC TANK

LIFT STATION

DRAINFIELD

- Distance from nearest well
- Distance from lake or stream
- Distance from occupied building
- Distance from property line
- Distance from bottom to water table

51'
91'
27'
—
—

—
—
—
—
—

—
—
—
—
—



Traut Water Analysis Lab

32640 Co Rd 133 St Joseph, MN 56374

320-251-5090

Water Analysis Report

Bill To: Amy Mondloch
PO Box 550
St Joseph, MN 56374

Amount Due:	\$55.00
Method of Payment:	Credit

Sample Number: **230812**
Report Date: June 9, 2023

Property: Cabin - Park Rapids, MN

Collected Date: June 7, 2023
Collected Time: 1200
Collected By: Amy Monloch
Received on Ice: Yes
Temperature: 14.4°C
Sample Condition: Accepted for analysis
Received Date: June 7, 2023
Received Time: 1635
Received By: KK

Ordered By: Amy Mondloch
Phone: 320-241-9617

Analysis Details

Parameter	Results	Units	Date	Time	Method		
					& RL	Analyst	MCL*
Total Coliform Bacteria	ABSENT	P/A	06/07/23	1640	1	KK	ABSENT
E. Coli Bacteria	ABSENT	P/A	06/07/23	1640	1	KK	ABSENT
Nitrates as N	<0.5	mg/L	06/07/23	1645	2	KK	10.0 mg/L

*MCL is defined as the Maximum Contaminant Level allowed by the Safe Drinking Water Act.

1 SM 9223 B (Colilert®-18)-97

2 EPA 300.0 Rev 2.1. Reporting Limit: 0.026 mg/L

*Sample was received outside of the recommended temperature range of 0 - 8° C

This sample **DOES** meet EPA guidelines for safe drinking water for the Analytes tested.

The above analysis was performed by or under the supervision of:
State of Minnesota Laboratory ID # 027-145-121
Mailing Address: 32640 Co Rd 133 St. Joseph, MN 56374

Kyle Hedding

This report can only be copied in its entirety unless approved in writing by Traut Water Analysis Lab.

The above chemical and bacterial determinations relate only to the sanitary quality of the water sample that was provided to Traut Water Analysis Lab and in no way implies or guarantees continued potability of said water source.

