

Soils Map

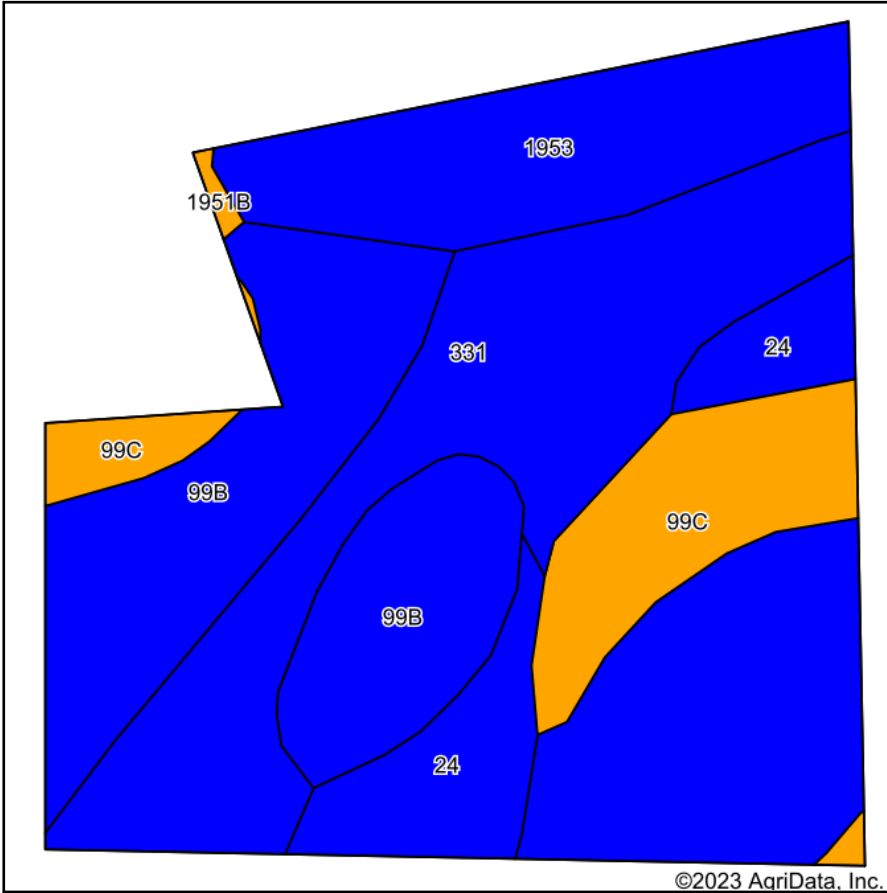

Soils data provided by USDA and NRCS.

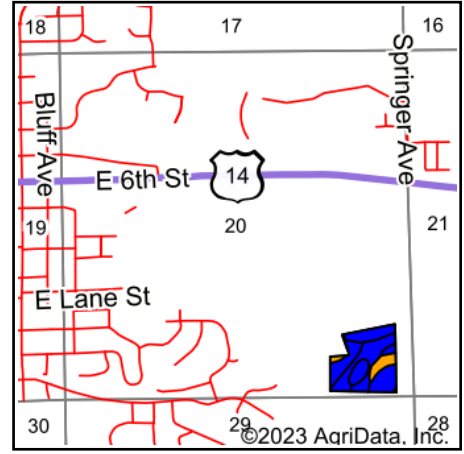

State: **Minnesota**
 County: **Winona**
 Location: **20-106N-10W**
 Township: **St. Charles**
 Acres: **19.58**
 Date: **12/19/2023**



Maps Provided By:



Area Symbol: MN169, Soil Area Version: 18

Code	Soil Description	Acres	Percent of field	Non-Irr Class Legend	Non-Irr Class *c	*n NCCPI Overall	*n NCCPI Corn	*n NCCPI Soybeans
99B	Racine silt loam, 2 to 6 percent slopes	7.89	40.3%		Ile	82	82	71
331	Tripoli silty clay loam	4.93	25.2%		IIw	88	76	88
1953	Marshan silt loam, loamy substratum	2.79	14.2%		IIw	88	88	82
99C	Racine silt loam, 6 to 12 percent slopes	2.19	11.2%		IIIe	85	85	74
24	Kasson silt loam	1.72	8.8%		Ile	90	90	82
1951B	Flagler sandy loam, bedrock substratum. 2 to 6 percent slopes	0.06	0.3%		IIIe	62	62	50
Weighted Average					2.11	*n 85.3	*n 82.3	*n 78.1

*n: The aggregation method is "Weighted Average using all components"

*c: Using Capabilities Class Dominant Condition Aggregation Method

Soils data provided by USDA and NRCS.